

Flowers for My Dollhouse

By Nancy Rhode

Here's a nudge toward spring. Make three types of flowers and some leaves this month, and make more plants for your garden using instructions from the next issue.

What You'll Need:

- Covered wire - 26 gauge
- Glue - thin (Sobo) and Tacky
- Acrylic paints: Green, Yellow
- Small paintbrush
- Silk ribbon - $\frac{1}{8}$ " Red, White or Pink
- Scissors
- Wire cutters
- Ruler
- Paper punch - $\frac{1}{4}$ " circle
- Needle and thread
- End papers (from beauty supply stores)
- Polymer clay
- Lined notebook paper - $\frac{1}{4}$ " spaces
- Toothpick
- Optional: Colored or painted papers, markers or colored pencils

Daisies

1. For stems, use fingers to spread green paint on a 6" length of covered wire. When dry, cut the wire into 2" pieces. Dip one end of each wire into a blob of unbaked polymer clay till dry.

2. Cut a strip of paper 2" X $\frac{1}{4}$ ". Cut edge of paper into fringe about $\frac{1}{16}$ " wide and $\frac{3}{16}$ " deep.

3. Run a thin bead of glue along the uncut edge. Attach one end of paper strip to top of stem with fringe above the yellow tip.

Hold the paper in place and roll the strip around the wire 3 or 4 times. Cut off excess paper. Let dry.

4. Open the petals, pressing them away from the center.

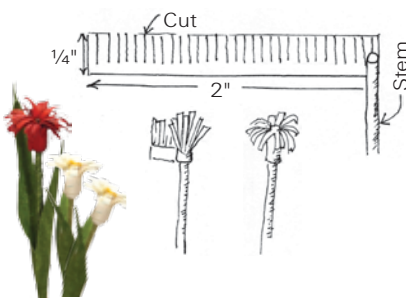

Punched Flowers

1. Make stems as for daisies.

2. Punch several circles of notebook paper. Cut off tip of toothpick. Place one circle in the palm of your hand and press down with the blunt end of the toothpick to make the circle edges curl. (You can also do this on a large flat eraser or mouse pad.)

3. With sharp end of toothpick, poke hole in center. Thread flower onto stem until yellow center is above punched circle. Dot glue around center to hold.

4. Brush outside of circle with thin glue to hold the shape.

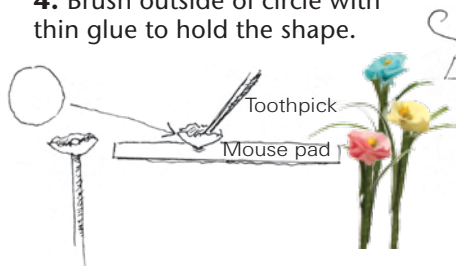

Variations: Use colored or painted papers. Try various shapes or sizes of punches. Draw on circles with markers or colored pencils. Stack circles.



Carnations

1. Make stem as for daisies, but do not dip tip in paint.

2. Make tiny running stitches along one edge of silk ribbon for about 2", leaving a 3" thread tail at beginning. Cut ribbon $\frac{1}{4}$ " from last stitch. Cut thread 3" long.

3. Pull ribbon together and tie thread ends together tightly to form ribbon into a ruffled ball. Glue knot.

4. Apply glue to tip of one stem. Insert tip into ruffle.

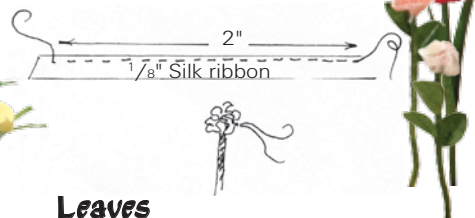

Leaves

Make leaves from painted end papers, painted or colored paper. Make them as thick or thin as you like and color them with paint, markers or colored pencils. Punch out or cut with scissors.

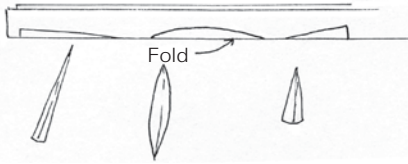

Punched leaves: Fold painted (on both sides) paper and crease. Position circle punch so it is half on the fold. Punch. Open leaf and glue to stem.

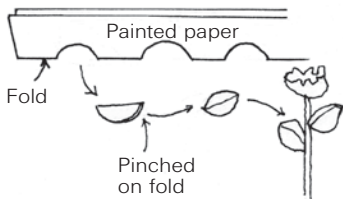

Cut leaves: Fold painted paper and crease. Cut a long or short triangle, or a curved shape tapering to points at both ends. Open leaf and glue to stem.

Fringe leaves: Cut a strip of painted paper the height of leaves, cutting the top edge irregularly. Cut slits from top edge to 1/8" above bottom edge. Glue to stem, wrapping lower edge one or more times.

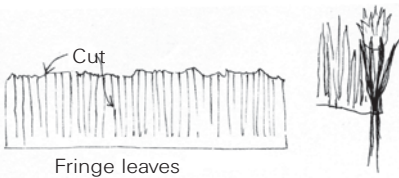

We'll learn to make more flowers, fillers and bows next time. ■

Miniature Collector will pay \$50 for published "Kids' Corner" projects. Criteria: Easy-to-follow, brief instructions; accurate scale; inexpensive; attractive; original; and fun! Send a sample project and instructions to: "Kids' Corner," Scott Publications, 2145 W. Sherman Blvd., Norton Shores, MI 49441-3434. Include postage if you want materials returned.

Miniature Museums

Denver Museum of Miniatures, Dolls & Toys

Denver, Colorado
Hours: Wed - Sat, 10a-4p
Sun, 1p-4p

Located in the
Historic Pearce
McAllister Cottage

1880 Gaylord Street
Denver, CO 80206
(303) 322-1053
Great gift shop
www.dmmtdt.org

Miniature Museum of Greater St. Louis

Saint Louis, Missouri
Hours: Wed-Sat, 11-4, Sun 1-4
ADM: Adults — \$5.00,
Seniors 62+ & Ages 13-18 — \$4.00,
Children 12 & Under — \$2.00

The museum features a 2-story shopping center, a replica of the St. Louis IX Basilica, a Georgian apartment building, numerous dollhouses, vignettes and roomboxes. Several Artisan cases highlight furniture, porcelain, silver, dolls, flowers, and more. Seasonal and special exhibits showcased regularly. Gift shop and Reference Library. The museum sponsors the Gateway Miniature Fair in April & October.

4746 Gravois Ave., St. Louis, MO 63116
(314) 832-7790
<http://miniaturemuseum.org>

Museum of Miniature Houses & Other Collections

Carmel, Indiana
Hours: Wed - Sat, 11-4 • Sun, 1-4
ADM: Adults — \$5
Children 10 & under — \$3, Members Free
Call for Group tours.

Near Indianapolis. Seven rooms of antique and new dollhouses, roomboxes, and vignettes, as well as displays of a wide range of collections. Exhibits change quarterly, and an audio self-tour is available. Wonderful shop for collectors.

www.museumofminiatures.org
111 East Main St., Carmel, Indiana 46032
317-575-9466

Smallsea - A metropolis in miniature

Carmel, California
Hours: 12-5 Wed. Thru Sat.
Come step into the miniature metropolis of Smallsea! Located in Carmel, CA, Smallsea depicts the city center of a fictional town in the English Edwardian era circa 1900 to 1905. From the bakery to the brewery, the seaport to the city's town hall it is all there to see in meticulous detail. In addition to the buildings there are horses and carriages, busses and early automobiles. A population of over 1,500 miniature dolls goes about the daily routines of city life. Smallsea, - A Metropolis in Miniature is the collection of Diane and Howard Birnberg. Artists and premier dealers from all over the world have assisted in making this miniature city come to life.

The Barnyard Shopping Center
Hwy 1, Suite F-22, Carmel, CA
831-250-7666 Office, 312-543-3678 Cell
www.smallseaminis.com



THE ART OF MAKING FURNITURE IN MINIATURE

by Harry W. Smith

In this volume, world-renowned miniaturist, Harry Smith reveals the techniques and secrets of mastering the construction of furniture in miniature. Designed for both beginners and advanced artisans, this book includes step-by-step instructions, detailed photographs, and 1"=1" scaled plans allowing exact measurements to be taken from these pages. Follow a master craftsman and make a masterpiece.

\$19⁹⁵

Code: HWSM

S&H: U.S. add \$5.00, Canada \$7.00, other foreign \$12.00.
Mich. res. add 6% tax. Payable in U.S. funds drawn on U.S. bank.



Scott Publications

30595 Eight Mile • Livonia, MI 48152-1798
800-458-8237
248-477-6650 FAX: 248-477-6795
www.scottpublications.com